



On May 6, 2026, City of North Vancouver Mayor and Council joined the North Vancouver Board of Education for a site visit to the Cloverley. Read more on page 4.

Community Building Opportunity

Earlier this week, special invitations were issued to children who will be transitioning from their current school to Cloverley to join the new school community for a Cloverley Connections Event on Tuesday, May 26, at Ray Perrault Park. Please note this event is a walking field trip for students and staff. We look forward to connecting with parents and guardians at a future date.

The event itinerary will be as follows:

- 12:40 p.m. - Students and designated staff depart from their current school sites and travel to Ray Perrault Park.
- 1:00 p.m.- Students arrive at Ray Perrault Park.
- 1:00–2:20 p.m. – Community-building activities
- 2:20 p.m. - Students and staff depart Ray Perrault Park and return to their schools prior to dismissal.

Students - we want to hear from you!

Current students, what words of encouragement do you have for those entering kindergarten this September?

Share your advice by sending an email to cloverley@sd44.ca, and watch for the next Cloverley Elementary newsletter to read what others have shared, too!

We look forward to welcoming all students to the new Cloverley Elementary School in September 2026. In case you missed them, the first two newsletters were issued April 24 and May 7, 2026, and are available on the [Cloverley Elementary website](#).

Grade 1 - 5 student transition/articulation details

As shared in our inaugural newsletter, school transitions are a regular part of the K-12 public education system. A layered process that is grounded in professional collaboration and strong home-school partnerships has been established to best support all students.

All students transitioning to the new Cloverley Elementary are included in the articulation process. Through Spring 2026, each child's current teacher (and school support team, if applicable) meet with Cloverley staff to share strengths, interests, and classroom strategies that have supported each student's success. These conversations help Cloverley staff intentionally plan class placement, instructional approaches, and welcoming classroom environments so that every student is known and supported from the very first day of school.

The articulation process may include additional layers of planning based on individual student learning and support needs. This typically involves input from the student's current case manager and provides opportunities for

families to share insights, helping to build a more complete picture of the supports, accommodations, and social-emotional considerations that have contributed to the student's success. This information supports proactive planning so that appropriate strategies and resources are in place at the start of the school year.

For students who require more coordinated and ongoing supports, more in-depth collaboration occurs between the current school team, Cloverley staff, and, where appropriate, school district support staff. In these cases, families will be contacted directly by a Learning Services Teacher (LST) from the Cloverley school team and/or school district staff in the coming weeks to connect, listen, and plan together for a smooth transition.

Families are always welcome to reach out to their current classroom teacher, case manager, or school principal if they have questions or would like to share additional information. We value families as essential partners in this process and remain committed to working together to support a smooth, positive transition to Cloverley.

Kindergarten transition

At Cloverley Elementary, we are committed to a thoughtful and supportive transition for our incoming Kindergarten students. This process begins before September and focuses on building strong connections with families and gaining an understanding of each child as a learner.

Each year, we look forward to welcoming young learners and their families to the North Vancouver School District (NVSD). We are here to work with you as you support your child entering kindergarten prepare to begin a new journey with us -- an adventure that includes learning, sharing and growing among a caring community of students, staff, families and community partners. As part of the NVSD's Kindergarten processes, we will host a Kindergarten Orientation event on June 10, 2026 (more information to follow) to enable the educational team to get to know your child and share a little bit more about kindergarten.

As part of these processes, families will also have the opportunity to complete a school-based questionnaire to share information about their child's strengths, interests, and needs. We also work in collaboration with community partners, including North Shore Supported Child Development, to support students who may benefit from additional services. Our District Principal of Inclusive Education and our Family of Schools Leader is liaising between the North Vancouver School District and families, childcare staff and community professionals

Our goal is for every child to arrive at Cloverley feeling known, supported, and ready to belong.

– Principal MacLeod

Also, families will be offered the opportunity to complete the optional UBC Childhood Experiences Questionnaire (CHEQ) which North Vancouver School District does in partnership with UBC Human Early Learning Partnership. The CHEQ provides valuable information to our schools about children's early experiences had before they started Kindergarten so that our teachers and school can support them better. This optional survey is conducted by all NVSD elementary schools and families have until October 31st to participate. You will be provided more information through upcoming communication at Kindergarten Orientation event and then again during Kindergarten Gradual Entry.

In September, all NVSD children will begin Kindergarten through a Gradual Entry process, allowing for a calm and positive start as they build comfort, confidence, and connections in their new environment.

We look forward to welcoming our new Cloverley learners and partnering with families for a strong start to their school journey.

Safe and active travel: Cloverley Elementary

As we progress towards opening Cloverley Elementary, we are encouraging families to start considering how they will travel to and from school each day.

Benefits of safe and active travel to and from school

Walking, cycling, and public transit are encouraged over driving to and from school. Some of the benefits of using these modes of transportation include:

- Improved physical and mental health and well-being, as students arrive to school energized, better rested and ready to learn.
- Stronger communities, as connections and friendships are made while walking, rolling, biking or taking transit to and from school.
- Healthier communities, as reduced congestion around school zones is better for pedestrian safety and the environment.
- Increased confidence around independent travel, as families develop healthy long-term habits, together.

Transportation improvements

Together, the North Vancouver School District (NVSD) and City of North Vancouver are working to upgrade transportation infrastructure to help students walk and roll independently and safely to Cloverley Elementary ahead of opening day in the school zone and catchment area.

Following the school opening, the City will continue to work with NVSD, the school's PAC, parents, and the surrounding community to understand emerging travel patterns to make further improvements.

To learn more about Cloverley Elementary's transportation improvements visit cnv.org/cloverley.



Practice before the first day of school

Practicing your new route to school before the first day helps students and families feel confident, prepared, and safe. Whether walking, cycling, or taking public transit, a trial run allows students to learn the route, estimate travel time, identify comfortable crossings and stops, and become familiar with traffic patterns.

Practice also helps reduce first-day stress and encourages healthy, independent, and sustainable transportation habits from the start of the school year.

The [City of North Vancouver has developed a Best Routes to School Map](#) to help families travel to and from Cloverley Elementary. We encourage families to review this map together to plan their route.

Drive to Five and parking

Walking, cycling and public transit are encouraged. If you need to drive to school occasionally, Drive to Five is recommended. This means parking 5 minutes away from the school and either walking together, or encouraging students to walk independently for the rest of the journey.

Drive to Five reduces vehicle traffic in the school zone and allows students to get their energy out and arrive to school ready to learn.

When Drive to Five is not possible, please refer to the [City of North Vancouver's Cloverley Parking Map](#) to understand the best areas for school pick up and drop off.

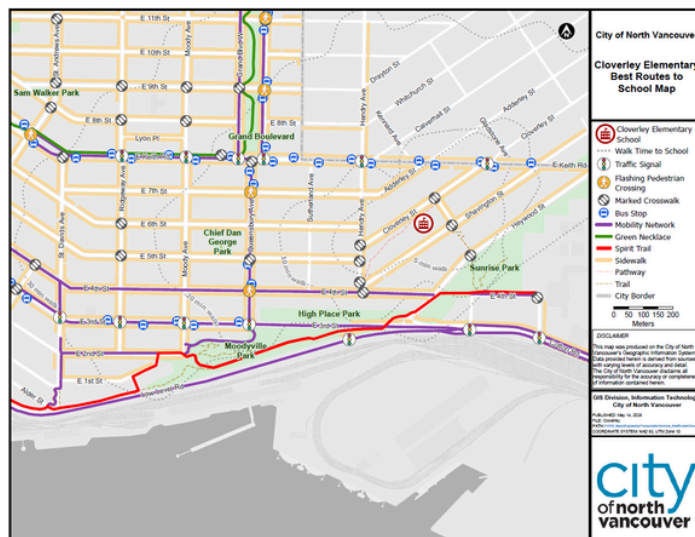

Cloverley Elementary Best Routes to School Map. Click map to enlarge image.

Childcare at Cloverley

CLOVERLEY ELEM
Childcare Play Areas

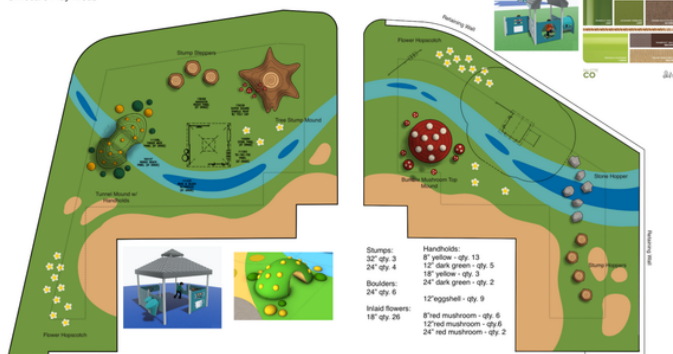

As previously detailed, the construction of the new Cloverley Elementary includes dedicated childcare space. Construction of this thoughtfully designed, purpose-built childcare space is well underway. Once completed, it will be one of the largest childcare facilities in the school district, providing a welcoming and engaging space for children to learn and grow.

One feature of the space will be its two outdoor play areas! These areas will include fully rubberized surfaces and a variety of creative elements designed to support play-based learning and exploration.

North Shore Neighbourhood House (NSNH) continues to oversee all program administration, including registration and waitlist management.

City of North Vancouver Mayor and Council and North Vancouver Board of Education tour the Cloverley Elementary building and grounds

The new Cloverley Elementary is made possible in part to the City of North Vancouver (CNV), and we are grateful for not only their financial contribution to this project, but for their enthusiasm and support as we strive to build a healthy and vibrant school community.

On Wednesday, May 6, CNV Mayor, Council and senior staff were joined by the Board of Education and NVSD senior staff to tour the Cloverley grounds and get a sneak peek inside the school building.



In case you missed it...

Calling all students: Art for Cloverley Elementary!



Cloverley Elementary will open with a population of close to 360 students, and we cannot wait to get to know each and every member of our learning community. We invite students to submit a self-portrait, drawn, painted or using other artistic materials of their choosing. Families, please scan your child(ren)'s finished pieces (or snap a photo) and send to cloverley@sd44.ca. Art will be compiled into a mural, printed and hung as a fence panel along the perimeter of the Cloverley Elementary grounds later this season.

Stay tuned for our next newsletter, coming June 7, highlighting learning design and spaces that will help make Cloverley Elementary a healthy and vibrant school community.